

MILDOON RESIDENCE

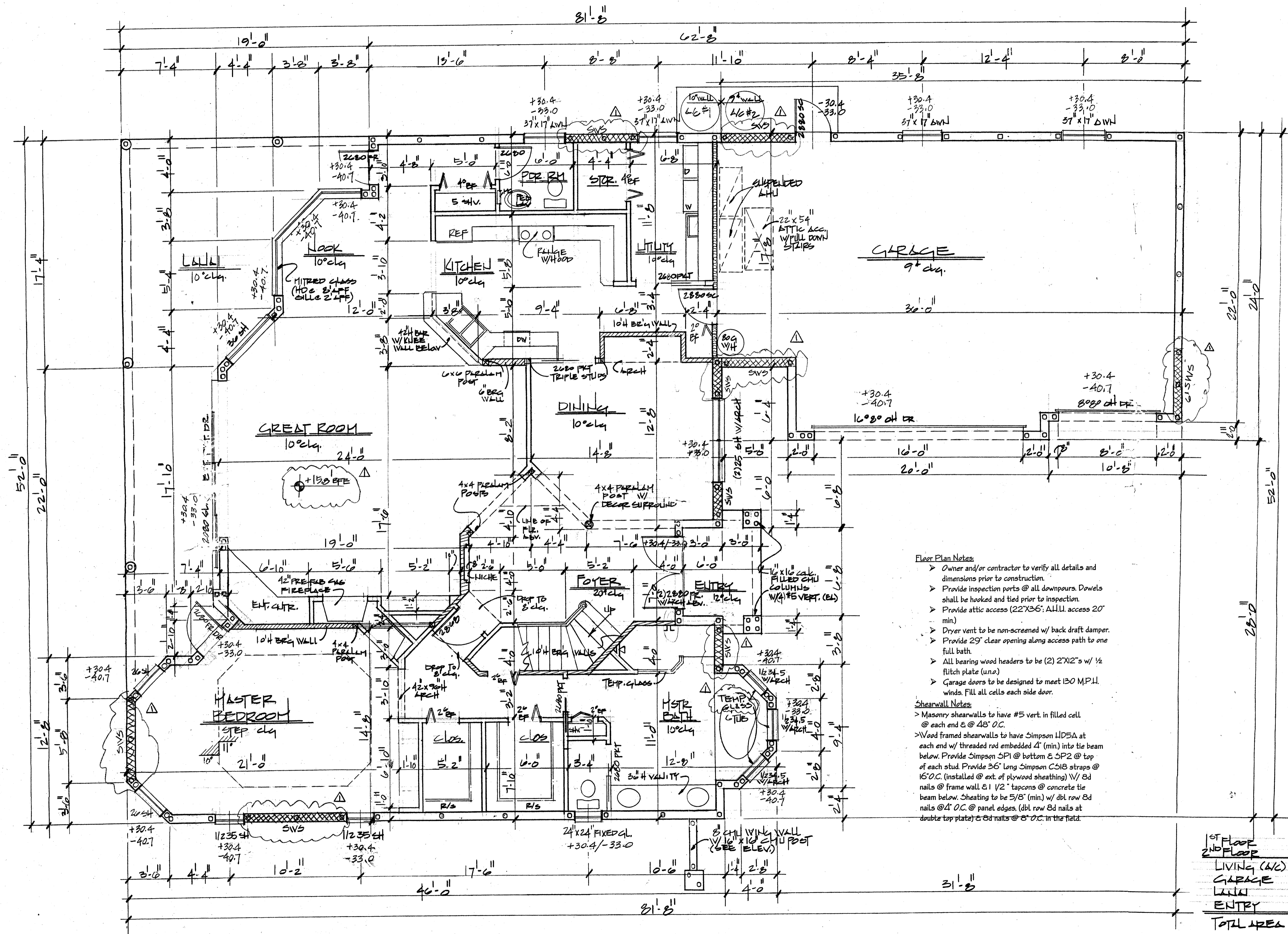

- Floor Plan Notes**
- Owner and/or contractor to verify all details and dimensions prior to construction.
 - Provide inspection ports @ all downspouts. Dowels shall be hooked and tied prior to inspection.
 - Provide attic access (22'x36"; All in access 20' min).
 - Dryer vent to be non-screened w/ back draft damper.
 - Provide 25' clear opening along access path to one full bath.
 - All bearing wood headers to be (2) 2"x12"s w/ 1/2" flitch plate (una).
 - Garage doors to be designed to meet 130 MPIL winds. Fill all cells each side door.
- Shearwall Notes**
- Masonry shearwalls to have #5 vert in filled cell @ each end @ 48" O.C.
 - Wood framed shearwalls to have Simpson LDSA at each end w/ threaded rod embedded 4" (min) into the beam below. Provide Simpson SPl @ bottom & SP2 @ top of each stud. Provide 36" long Simpson C518 straps @ 16" O.C. (installed @ ext. of plywood sheathing) w/ 8d nails @ frame wall & 1/2" tapcons @ concrete tie beam below. Sheathing to be 5/8" (min) w/ dbl row 8d nails @ 4" O.C. @ panel edges, (dbl row 8d nails at double top plate) & 8d nails @ 5" O.C. in the field.

1 ST FLOOR	2461
2 ND FLOOR	1405
LIVING (w/c) AREA	3800
GARAGE	808
LOUN	390
ENTRY	48
TOTAL AREA	5118

1ST FLOOR PLAN 1/4" = 1'-0"

These Drawings when signed and sealed are an indication that I, the Professional Engineer, have reviewed the structural components for conformance with the requirements of the 2001 Florida Building Code of section 1606 (utilizing ASCE 7-5) in accordance with 2001 Florida Building Code roof truss design. Importance factor for doors un-protected in accordance with roof trusses shall be +/.055.

Ivan R. Dory P.E.
 100 N. River Rd. (S-3)
 Sarasota, FL 34232-1701
 (941) 927-7501

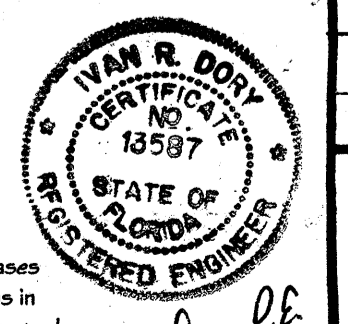

DATE:	8.15.03
SCALE:	1/4" = 1'-0"
REVISIONS:	
	2.11.04
SHEET	A-2
	12

4" 00

13' 10" 3 1/2
1 15 1/2

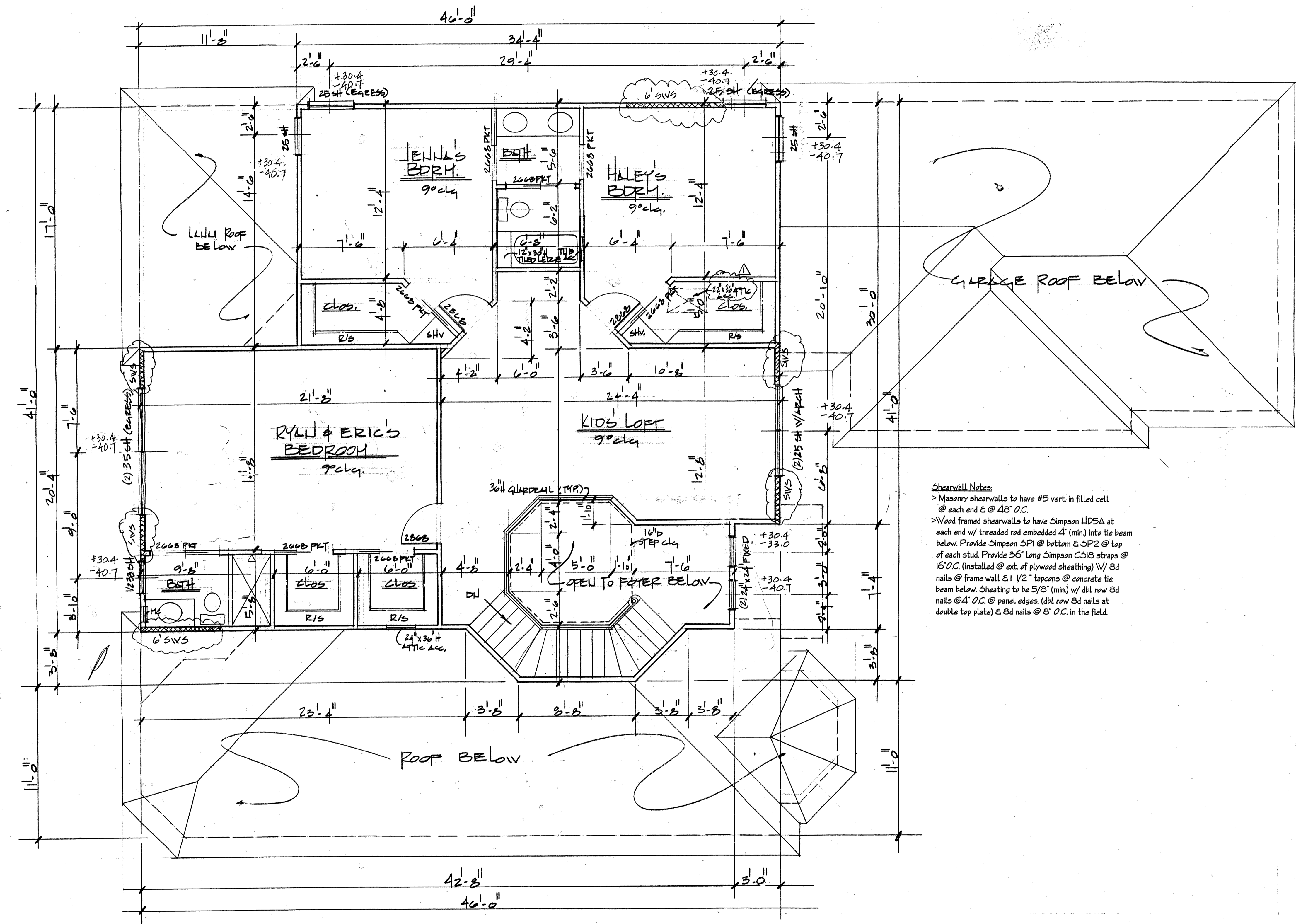

Shearwall Notes

- > Masonry shearwalls to have #5 vert. in filled cell @ each end @ 48" O.C.
- > Wood framed shearwalls to have Simpson SDSA at each end w/ threaded rod embedded 4" (min) into the beam below. Provide Simpson SP1 @ bottom & SP2 @ top of each stud. Provide 36" long Simpson C518 straps @ 16" O.C. (installed @ ext. of plywood sheathing) w/ 8d nails @ frame wall & 1 1/2" tapcons @ concrete tie beam below. Sheathing to be 5/8" (min) w/ dbl row 8d nails @ 4" O.C. @ panel edges (dbl row 8d nails at double top plate) & 8d nails @ 8" O.C. in the field.

2ND FLOOR PLAN 1/4" = 1'-0"

Handwritten notes: 20, 10, 10, 10, 10, 10, 15, 15

MILDOON RESIDENCE

DATE:	8.15.03
SCALE:	1/4" = 1'-0"
REVISIONS:	Δ 2.11.04
SHEET	Δ-3
	12

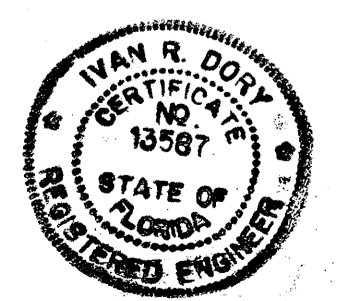

These Drawings when signed and sealed are an indication that Ivan R. Dory, P.E., has reviewed the structural components for conformance with the requirements of the 2001 Florida Building Code for the following criteria: ISO MP11 three second gust wind velocity. Wind pressures computed on the bases of section 1606.1 (utilizing ASCE 7-98 main wind force resisting system forces and components and cladding due to un-protected openings). Calculations in accordance with 2001 Florida Building Code 1606.15 indicate that structure will be considered as 'partially enclosed' with internal pressures included in wind roof truss design. Importance factor of 1.0 exposure B building category - building similar disposition - partially enclosed building exterior glazed windows and doors un-protected in accordance with 2001 Florida Building Code section 1606.14 internal pressure coefficients to be applied to wind load design of wood roof trusses shall be +/- 0.55.

Ivan R. Dory, P.E. #13587 (Struct)
 1300 N River Rd. (S-3)
 Venice, FL 34293-4701
 (941) 487-7501

26 Dec 03
 16 Feb 04